

FRONT VIEW OF STAINLESS STEEL SLUICE GATE AFTER INSTALLATION

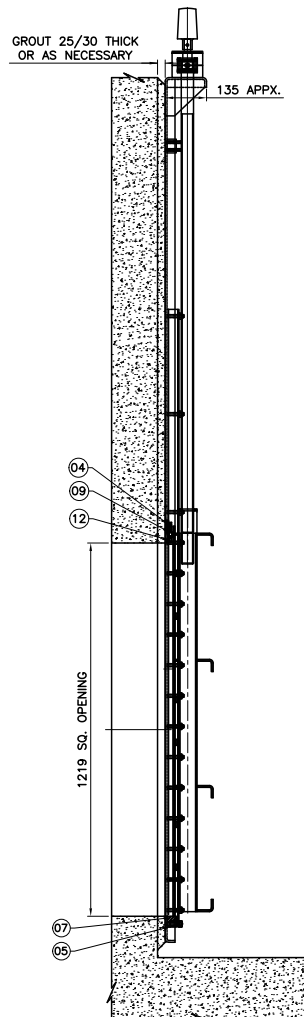

SIDE VIEW WITH CUT SECTION OF WALL FOR CONVENTIONAL BOTTOM CLOSURE GATE

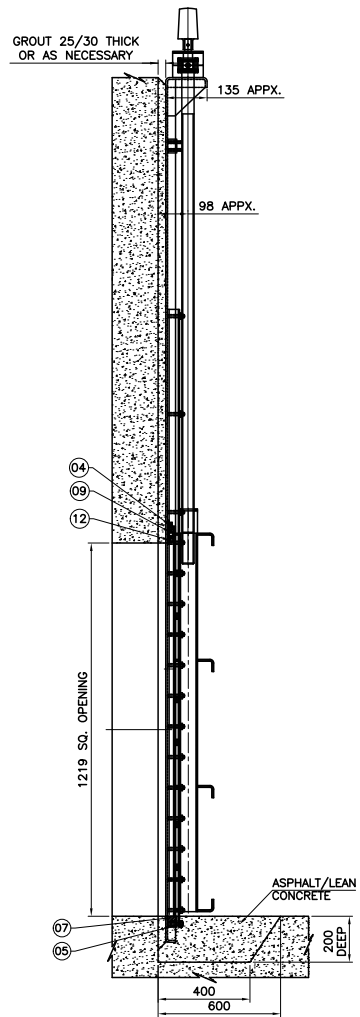

SIDE VIEW WITH CUT SECTION OF WALL FOR FLUSH BOTTOM CLOSURE GATE

16	UPPER PLATE	HDPE
15	LOWER PLATE	
14	END CAP FOR SPINDLE CONNECTION	ASTM A216 WCB
13	SIDE GUIDE	HDPE
12	TOP SEAL SUPPORT	
11	OVER TRAVEL STOP	
10	STEM	STAINLESS STEEL EN 1.4401 (316)
09	TOP SEAL	EPDM RUBBER
08	SIDE SEAL	
07	FLUSH BOTTOM RUBBER SEAL	LEADED GUN METAL BS EN-1982 LG2
06	THRUST NUT	
05	BOTTOM SEAL RETAINER	STAINLESS STEEL EN 1.4401 (316)
04	TOP SEAL RETAINER	
03	SIDE SEAL RETAINER	
02	SHUTTER	
01	FRAME	
Sr.	DESCRIPTION	MATERIAL

NOTES :-  
 (1) ALLOWABLE DEVIATION FOR DIMENSIONS WITHOUT SPECIFIED TOLERANCES TO BE AS PER IS : 2768.  
 (2) ALL FASTENERS (NUTS, BOLTS & WASHERS) FOR GATE ASSEMBLY TO BE OF STAINLESS STEEL EN 1.4401 (316)  
 (3) ALL STAINLESS STEEL FABRICATED PARTS TO BE BLAST CLEANED TO REMOVE SURFACE CONTAMINATION AND THEREAFTER PICKLED AND PASSIVATED

(4) ADHESIVE CAPSULE/CHEMICAL CAPSULE & CHEMICAL ANCHOR FASTENERS TO BE ARRANGED BY CLIENT  
 (5) APPROX. OUTER DIMENSIONS OF GATE ASSLY IS 1439 x 2824 x 135mm  
 (6) REFER DRG. NO. JE/SG/GEN/1491-R1 FOR SECTIONAL DETAILS.

**WATERFRONT FLUID CONTROLS**  
 MARITIME HOUSE (SUITE 8),  
 143 WOODVILLE ST, GLASGOW, G51 2RQ  
 WEB: www.waterfrontfc.co.uk  
 TEL: (44) 0141-445-3781  
 FAX: (44) 0141-445-5101

REV	DATE	DESCRIPTION	APPROVAL
01	25.10.19	DIM. 226.5 & 86 ADDED.	P.S.

DRAWN BY: S.S.V.	PROJECT: ----	GENERAL TOLERANCES: MACHING: ±0.2mm DIM'S: <1000mm ±1.5mm >1000mm ±2.0mm	FIRST ANGLE PROJECTION	DO NOT SCALE FROM THIS DRAWING
CHECKED BY: D.K.	CLIENT NAME: ----	THIS DOCUMENT IS COPYRIGHT AND IS THE PROPERTY OF WATERFRONT FLUID CONTROLS. IT MUST NOT BE COPIED OR DISCLOSED TO A THIRD PARTY, INCLUDING MANUFACTURE OF THE PRODUCT SHOWN THEREIN, WITHOUT THE WRITTEN CONSENT OF THE COMPANY.		
APPROVED BY: D.K.	LOCATION: ----	© 2009 WATERFRONT FLUID CONTROLS		

TITLE: DETAILS OF STAINLESS STEEL FACE WALL MOUNTING, UPWARD OPENING, SELF CONTAINED, NON-RISING SPINDLE, RESILIENT SEATED, SLUICE GATE SUITABLE FOR 6M SEATING AND 3M UNSEATING WATER HEAD. GATE SIZE 1219 SQ.	DRAWING NUMBER: JE/SG/GAC/FBF/10833-A
MATERIAL: SEE MATERIAL NOTES	REV NUMBER: R1
	SHEET NUMBER 1 OF 1