

1 2 3 4 5 6 7 8 9 10

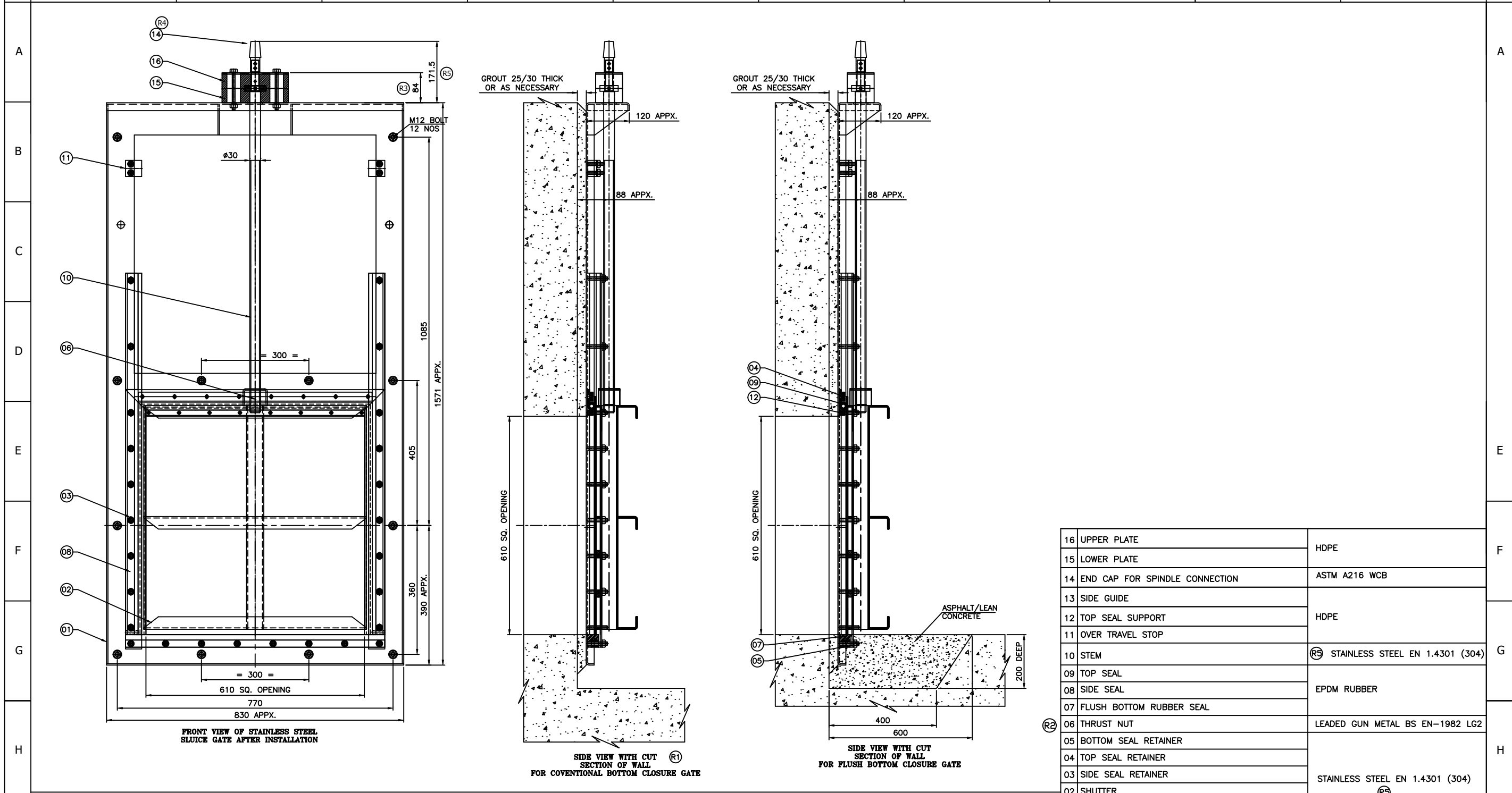

16	UPPER PLATE	HDPE
15	LOWER PLATE	HDPE
14	END CAP FOR SPINDLE CONNECTION	ASTM A216 WCB
13	SIDE GUIDE	
12	TOP SEAL SUPPORT	HDPE
11	OVER TRAVEL STOP	
10	STEM	(R5) STAINLESS STEEL EN 1.4301 (304)
09	TOP SEAL	
08	SIDE SEAL	EPDM RUBBER
07	FLUSH BOTTOM RUBBER SEAL	
06	THRUST NUT	LEADED GUN METAL BS EN-1982 LG2
05	BOTTOM SEAL RETAINER	
04	TOP SEAL RETAINER	
03	SIDE SEAL RETAINER	STAINLESS STEEL EN 1.4301 (304)
02	SHUTTER	(R3)
01	FRAME	
Sr.	DESCRIPTION	MATERIAL

WATERFRONT FLUID CONTROLS
 MARITIME HOUSE (SUITE 8),
 143 WOODVILLE ST, GLASGOW, G51 2RQ
 WEB: www.waterfrontfc.co.uk
 TEL: (44) 0141-445-3781
 FAX: (44) 0141-445-5101



TITLE:
 DETAILS OF STAINLESS STEEL FACE WALL MOUNTING, UPWARD
 OPENING, SELF CONTAINED, NON-RISING SPINDLE, RESILIENT
 SEATED, SLUICE GATE SUITABLE FOR 6M SEATING AND UNSEATING
 WATER HEAD. GATE SIZE 610 SQ.

DRAWING NUMBER:
 JE/SG/GAC/FBF/10372

REV NUMBER: R7

MATERIAL: SEE MATERIAL NOTES

SHEET NUMBER 1 OF 1

NOTES :-
 (1) ALLOWABLE DEVIATION FOR DIMENSIONS WITHOUT SPECIFIED TOLERANCES TO BE AS PER IS : 2768.
 (2) ALL FASTENERS (NUTS, BOLTS & WASHERS) FOR GATE ASSEMBLY TO BE OF STAINLESS STEEL ASTM A276 TYPE 304.
 (3) ALL STAINLESS STEEL FABRICATED PARTS TO BE BLAST CLEANED TO REMOVE SURFACE CONTAMINATION AND THEREAFTER PICKLED AND PASSIVATED.
 (4) ADHESIVE CAPSULE/CHEMICAL CAPSULE & CHEMICAL ANCHOR FASTENERS TO BE ARRANGED BY CLIENT
 (5) APPROX. OUTER DIMENSIONS OF GATE ASSLY IS 830 x 1571 x 120mm
 (6) REFER DRG. NO. JE/SG/GEN/1490-R1 FOR SECTIONAL DETAILS.

R7	25.01.24	SHUTTER MODIFIED	BP	SJ
(R6)	28.02.22	DIMENSION MODIFIED	BP	SJ
(R5)	23.11.21	MATERIAL GRADE MODIFIED	BP	DD
(R4)	28-01-20	END CAP UPDATED	GDC	SA
(R3)	24.10.19	DIM. 204 & 84 ADDED.		SA
(R2)	28.11.17	THRUST NUT MATERIAL CHANGED		SA
(R1)	24.6.17	SECTIONAL VIEW ADDED		SA
REV	DATE	DESCRIPTION	REV.BY	CHD.BY

DRAWN BY: Basant	PROJECT: ----	GENERAL TOLERANCES: MACHINING: ±0.2mm DIMS: <1000mm ±1.5mm DIMS: >1000mm ±2.0mm	FIRST ANGLE PROJECTION	DO NOT SCALE FROM THIS DRAWING
CHECKED BY: D.K.	CLIENT NAME: ----	THIS DOCUMENT IS COPYRIGHT AND IS THE PROPERTY OF WATERFRONT FLUID CONTROLS. IT MUST NOT BE COPIED OR DISCLOSED TO A THIRD PARTY, INCLUDING MANUFACTURE OF THE PRODUCT SHOWN THEREIN, WITHOUT THE WRITTEN CONSENT OF THE COMPANY.		
APPROVED BY: D.K.	LOCATION: ----	© 2009 WATERFRONT FLUID CONTROLS		

1 2 3 4 5 6 7 8 9 10